



A Quarterly Newsletter of the

Salisbury Oaks Neighborhood Association [SONA]

P.O. Box 12042

Des Moines, Iowa 50312

www.sonadsm.com

Edited by Barb Schmidt

Neighbors joining to build a better community

Vol. XXVI

Summer 2025

Join your neighbors for...

National Night Out & SONA's Annual Picnic

Tuesday, August 5

5:30 Social, 6:00 Potluck

Greenwood Park,

Jay Spence Shelter

Splash Pad will be open till 8:00 pm



Your SONA dues provides:

Pulled Pork, Burgers, Hotdogs,
Beverages, Dinnerware

Bring a salad, side dish, or dessert

18th Annual Neighborhood Garage & Plant Sale was a huge success!!

Fourteen households hosted individual garage sales and at least 12 more additional households contributed items for the association sale. The proceeds from the SONA garage, plant, and bake sale was close to \$1,200

Many thanks to the neighbors who volunteered, donated items, baked cookies, and potted plants for the garage and plant sale. One hundred per cent of those sales benefits our neighborhood association.

Mary Shotwell
Karen Halter
Cathy McMullen
Jean Williams
Karen Jackson
Liz Neumann
Martha Crist

Darlene & Ken Brickman
Andy & Barb Nish
Fred & Charolette Hubbell
John Schmidt & Deb Wiley
Mark & Barb Schmidt
Sheena Thomas
Yolanda Cintron

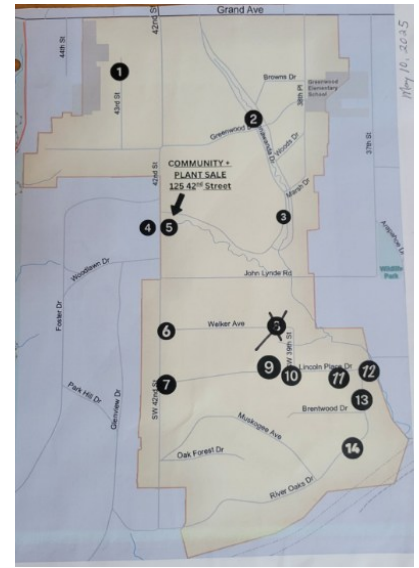

(map of 2025 garage sales)

Our apologies for any neighbors that we missed thanking in this newsletter. All donations were very much appreciated and contributed to a very successful garage/plant sale.

Des Moines Water Works “Flume”



Des Moines Water Works has partnered with Flume Water to help DMWW customers monitor their water usage. By installing a smart water monitor, customers can review and adjust their consumption habits to save water and money.

Flume is a water usage monitor that provides you the information on how many gallons you are using for routine tasks as well as any leaks. DMWW is offering this system for \$85



(free shipping) after \$25 rebate. This unit usually sells for \$249. Installation is simple and takes less than 15 minutes.

Even the tiniest drips can add up to thousands of gallons of wasted water and higher bills. A shower dripping just 10 drips per minute wastes 500+ gallons/year. A faucet leaking 1 drip per second can add up to more than 3,000 gallons/year according to DMWW.

We decided to try it and the next day we were alerted to a leaky garden hose that was wasting 1/2 gallon per hour. If you check your phone regularly you can detect that leaky toilet or garden hose that was left on. DMWW claims that 70% of their customers have discovered a leak. The end result should be reducing your water bill and conserving water. Photos: Flume sending unit to transmit data to DMWW and property owner; and Flume meter.

This review was submitted by Mark and Barb Schmidt

SONA's Houses Have History; A Usonian - Inspired House 300 Tonawanda Drive

One of the more unique houses in the neighborhood is the home of Karen and Warner Jackson located at 300 Tonawanda Drive (the NW corner of Tonawanda and Greenwood).



The house was built in 1958 by Dr. Homer and Maida Wichern on two lots that were subdivided from the home at 4137 Greenwood Drive . Homer passed away in 1988 but Maida stayed in the home until her death in 2010. The Jacksons purchased the home from Maida's estate in 2011.

The house was designed by a local architect, George Russell who was originally from Oskaloosa, worked for a time in California and also worked in Des Moines on various projects such as the Ruan I & II buildings. [Architectural firm was Kendall Griffith Russell Artiaga]. The home was built by Neumann Brothers Construction.

The home's design is based on Frank Lloyd Wright's concept of "Usonian" houses which was Wright's vision in his later life for landscape and simplicity in architecture. Typical features of a Usonian house are: dominant horizontal lines; roofs with large overhangs; natural materials that look like what they are such as brick, wood, concrete and glass; rows of casement windows; an organic setting; floor plans and overall design based on a grid; open living spaces with adjacent cooking/dining areas; concrete slab floors; and built in or modular furniture.

Russell incorporated many of these features into the Wichern house. The horizontal lines are apparent from the exterior. The house has large roof overhangs. The primary material of the house is brick, with many of the interior walls also being brick. There are rows of casement windows. The living areas have red concrete floors.

One of the most interesting Usonian features of the house is that it is all laid out on a grid of equilateral triangles. The triangles are etched in the concrete floors. There are NO right angles in the house, including the fact that the bathtubs are triangular. The bricks that line both interior and exterior walls were custom cast with the appropriate angles!

When the Jacksons purchased the house in 2011, the house was as it was built in 1958, including all the 1958 appliances. Needless to say, it needed some updating. The Jacksons hired Silent Rivers Design/Build to help them restore the house while updating necessary systems such as HVAC and grounded outlets. The only modification they made was the addition of a screened porch off the back side of the house..which of course is a triangle.

It is a wonderful house to live in... all the living spaces are on one level. The views from all the rooms look out into trees . The site is home to lots of wildlife, birds, raccoons, rabbits, foxes, and for the last two years a pair of red tailed hawks have nested on one of the pine trees!

Article submitted by Karen & Warner Jackson

Upcoming EVENTS at the Salisbury House & Gardens

CELEBRATE SALISBURY HOUSE'S CENTENNIAL IN STYLE!

GATSBY GALA

AUGUST 23 2025

SALISBURY
HOUSE & GARDENS

Celebrate 100 years of Salisbury House the same way the Weeks family would have. Join us for an evening of prohibition-era cocktails, hors d'oeuvres and a three-course dinner from Tangerine Food Company, modern tunes and roaring classics performed by Diamond Empire Band, and an after party in a speakeasy featuring DJ Big Lare.

Tickets \$350

Salisbury House & Gardens 515-274-1777



Ghoulish Gala...an eerie elegance!

Saturday, October 18

6:00—11:00 PM Tickets \$150 per person

Welcome to Ghoulish Gala, an annual signature fundraiser which plunges the elegant manor into a macabre mansion.

Drift through our historic halls and discover exciting surprises and entertainment around each twist and turn. As the witching hour approaches, we'll gather for a supernatural dance party sure to move even the most stoic of vampires out of their coffins. If you find yourself in need of sustenance, feast on heavy hors d'oeuvres and indulge in a variety of tasty libations as you mingle with the other ghouls gathered. Uncover unique and engaging entertainment located throughout the first and second floors of the house. Past activities include caricature artists, pop-up tattoo + piercing parlor, crystal keychain making, fortune telling, tea leaf reading, tarot, axe throwing, and more. At 8 o'clock, the souls of the house drift into the Historic Garage and tented Cobblestone Courtyard to enjoy delectable desserts and a legendary dance party! Dress to impress: wear your most glamorous and ghastly take on black tie. It is sure to be a deathly good.

Tickets at <https://salisburyhouse.org/events/>



Calendar of Upcoming Events

Aug. 5, Tues. Annual picnic/Quarterly mtg. Greenwood Park 5:30 social, 6:00 eat

Oct. 1 Board Meeting at Caribou Coffee on Ingersoll, 6:30 pm

Nov. 13 Quarterly meeting, Salisbury House, 6:00 social, 6:30 program

Lauren Kollauf, Executive Director, The Avenues

Additional Board Meetings TBA

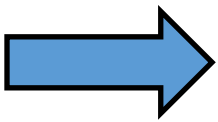

Renew or become a member of
Salisbury Oaks Neighborhood Association

Name(s): _____

Address: _____

Telephone: _____

E-mail _____

Dues: \$10 per household per calendar year Join now for 2026

Mail this form with your check to:

SONA, PO Box 12042, DM, IA 50312

OR use Venmo...



venmo

Support the association that supports you!!!

2024-25 SONA Board of Directors

President...Angel Erickson

Vice-president...Martha Crist

Treasurer...Mark Slocum

Secretary...J. Mark Schmidt

At-Large Directors:

Kyle Lovseth

Mariah Klemp

Yolanda Cintron

Angel.m.Erickson@gmail.com

Mc2crist@gmail.com

m.slocum@outlook..com

jmarkschmidt42@gmail.com

Kyle.lovseth@gmail.com

Mariah@sweethomedsm.com

ycblazek@gmail.com

www.sonadsm.com